



PRINCES COURT, 88 BROMPTON ROAD,
KNIGHTSBRIDGE SW3

Asking Price £1,620,000 Leasehold

T. +44 (0) 20 7935 0011
E. enquire@napierwatt.co.uk
WWW.NAPIERWATT.CO.UK

NAPIER WATT

PROPERTY CONSULTANTS

Description

This sensational apartment is situated on the fourth floor (with lift) of a popular portered building and offers views over Brompton Road and across to the iconic Harrods Building. The property comprises of a spacious reception room, benefiting from large windows that allows for plenty of natural light and a dining area to the side. The master bedroom is en-suite with built in storage and there is one further double

bedroom with shower room. There is a fully fitted Scavolini kitchen incorporating Miele and Siemens appliances. The inventory includes Busado furniture and the property also benefits from Air conditioning with latest technology VRV by Mitsubishi. Princes Court is a fully portered block with CCTV security, block heating and constant hot water. Situated on Brompton Road, Hyde Park and exclusive shopping on Sloane Street are both easily accessible on foot.

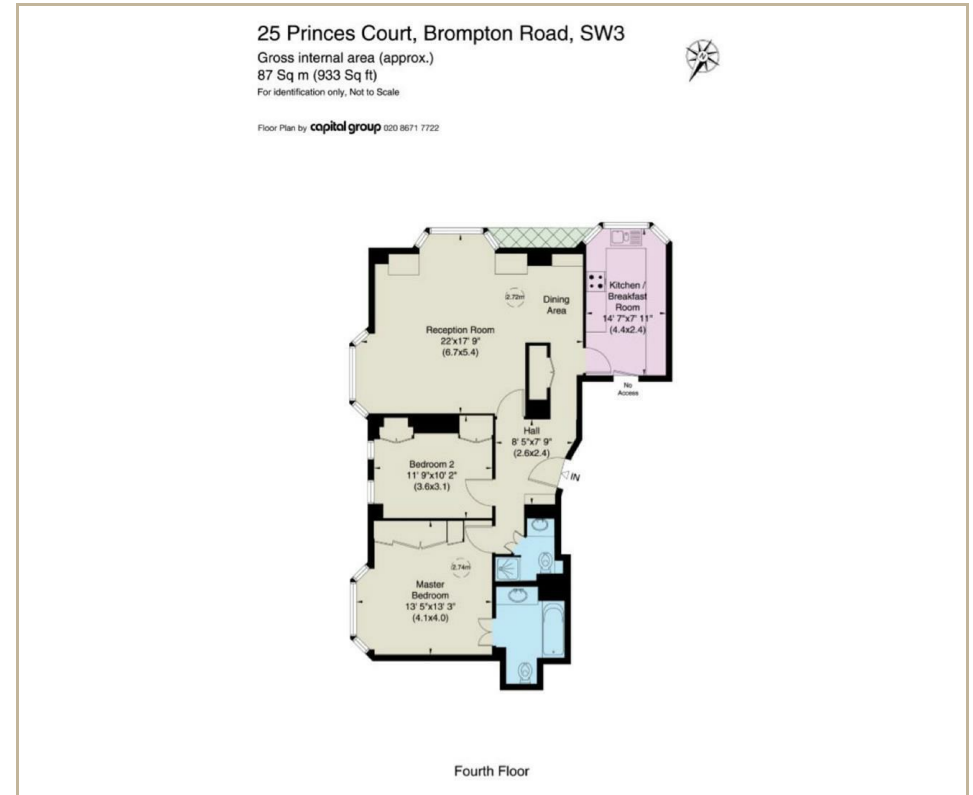

TERMS

For Clarification we wish to inform prospective purchasers that we have prepared these sales particulars as a general guide. We have not carried out a survey, nor tested the services, appliances and specific fittings. Room sizes are approximate and rounded: they are taken between internal wall surfaces and therefore include cupboards/shelves, etc. Accordingly, they should not be relied upon for carpets and furnishings. Formal notice is given that all fixtures and fittings, carpeting, curtains/blinds and kitchen equipment, whether fitted or not, are deemed to be removable by the vendor unless specifically itemised within these sales particulars.

T. +44 (0) 20 7935 0011
 E. enquire@napierwatt.co.uk
WWW.NAPIERWATT.CO.UK

NAPIER WATT
 PROPERTY CONSULTANTS